

RDNIMOS

– Electric Handheld Cleaner Specification

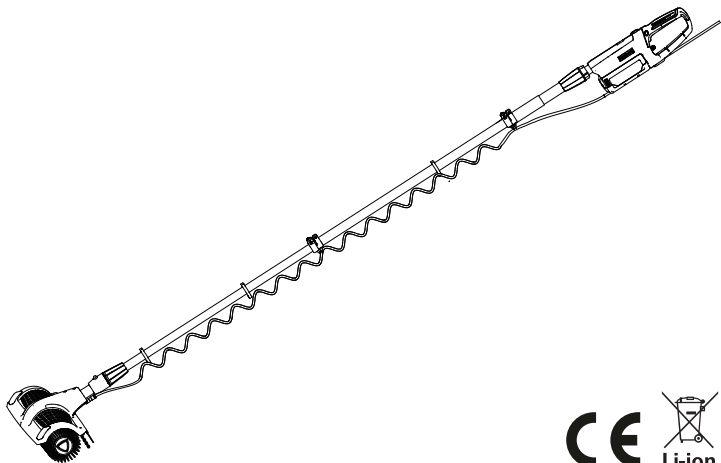

Suzhou Radiant Photovoltaic Technology Co., Ltd
No.636 Zixu Road,Xukou Town,Suzhou, Jiangsu,China

Table of contents

Significant safety specification	P3
Product accessories list and tractor parameter	P4-5
Product assembly and use	P6-10
Usage scenarios	P11-12
Product clean	P13
Common malfunctions and solutions	P14
Illustrative table for toxic and detrimental substance elements of the product	P15
Product guarantee	P16-17

WARNINGS:

These warnings are applicable for this product, all tools and accessories as well as any necessary chargers or power adapters in use.

In order to lower the risks of fire burning, electric shock and injuring:

- This product is unavailable for the disabled with physical, sensual or mental disabilities or people without relevant experience and knowledge (including children) only when there are guardians who will surveille or instruct their behaviors to ensure their safety in using this product.
- Please avoid treating this product as a toy. Particular close attention should be paid when children are using or accessing to the product. Please keep an eye on children to ensure that they won't play with this product as a toy.
- Please use the product according to the methods in the operation instruction manual only.
- Please avoid touching the plug with wet hands.
- Please stop using if the cable or the plug is broken.
- Please avoid using the product on rainy days.
- Please stop using and contact the after-sale helpline if the product fails to operate in line with its designed manners, falls from a height or into water or is damaged, placed outdoors or struck heavily.
- Please contact the after-sale helpline in need of maintenance or fix. Please avert disassembly of the product since improper disassembly operation may generate electric shock or fire disaster.
- Warning: Centralizing the rolling brush in one panel for a long time during using may generate risk of damaging the panel. Thus, please avoid centralizing the rolling brush in one panel for long in using.
- Warning: Please stop using if the static-removing bar is damaged or lost. Replace one before using to prevent the machine or human body from damage or discomfort.
- Please avoid incinerating the product even it is severely broken since the battery may explode in fire.
- Do not operate the release button frequently. The escape button function is used for escape only.

Product accessories list and tractor parameter

- Product accessories list

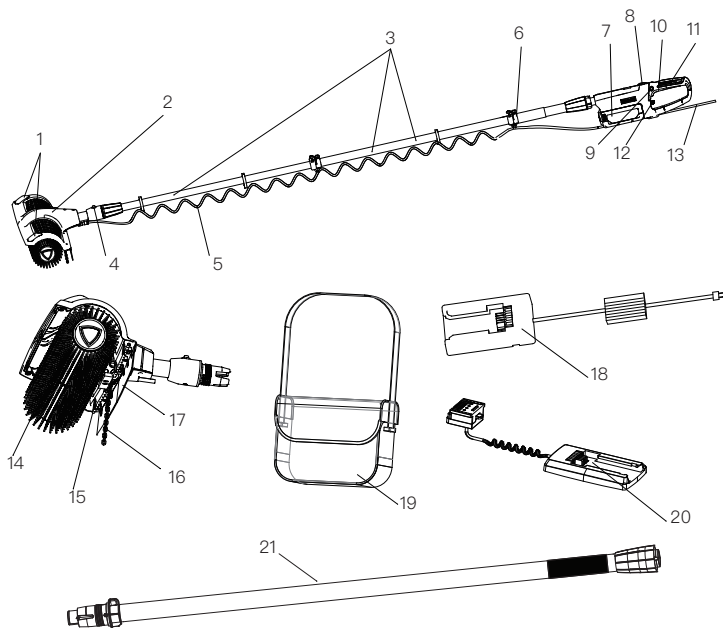

1. Lighting lamp	2. Cleaning handpiece	3. Expansion pipe	4. Switch of the lighting lamp	5. Expansion water pipe
6. Anti-skid lever	7. Battery pack	8. To erase button	9. Self-locking press button	10. Start switch
11. Hand lever	12. Cruise switch	13. Water inlet	14. Hair brush	15. Spray pipe
16. Static-removing bar	17. Water-blocking bar	18. Charger	19. External power pack	20. External electric supply socket
21. Extension bar assembly (optional)				

Product accessories list and tractor parameter

- Tractor parameter

Product name	Lithium handheld cleaner
Electric machine	120W
Working voltage	25.2V
Charger	Voltage 29.4V Charging current 3A
Charging time of battery	3.5 hours
Battery pack capacity	9.6 ampere-hour
Battery pack: Pluggable or not	Yes
Product weight	8.5 kg
Extension length	3.55 m



Please read the instructions and precautions carefully before use
Non operating personnel are not allowed to enter the work area and keep a safe distance to prevent danger.

Please wear protective goggles and ear muffs. Do not use this product outdoors in rainy days.

Product assembly, use and usage scenarios

- Product assembly and use

Please be sure to unplug the charging cable before installation or removal.

The product is made up by four parts:

Hand lever, Battery pack, Expansion rod and Cleaning handpiece

Assembly

Install the rear end of the telescopic rod into the assembly position of the telescopic rod of the head component in turn and tighten the connecting sleeve of the rear end. The battery is packed into the handle battery compartment. Install the handle assembly position at the front end of the telescopic rod, tighten the front end connecting sleeve, and install the water pipes into the clamping water pipe position respectively. Insert the nose quick plug connector to complete machine assembly.

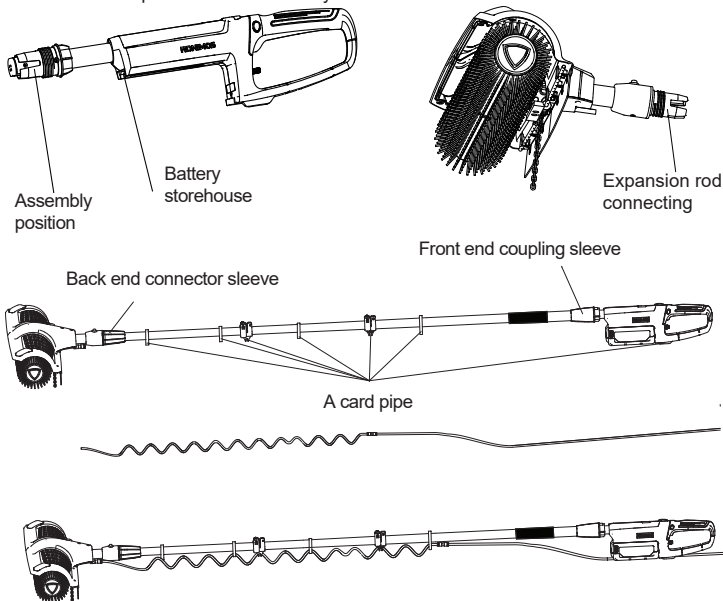

Light display

Description: as the picture shown below, the light display adopts a 5-lamp pattern with the front 4 lamps as electric quantity display lamps.

If the 4 lamps are all lightening, it suggests that the electric quantity is 100%.

If 3 lamps are lightening, the quantity is 70 %.

If 2 lamps are lightening, the quantity is 40 % while the quantity is reduced to 10% if there is only 1 luminous lamp, suggesting that the machine will stop working in 20 minutes.

The red light backmost is always off when the work starts normally and if it is lightening in common start, it indicates that the machine is disconnected. And if it is flickering in common start, it shows that the machine is under a short circuit.

Static-removing bar

Warning: the static-removing back can efface effectively the machine static at work. If it is broken or lost, please stop using at once for the reason that if the machine works without a static-removing bar, its static cannot be removed efficaciously and will do harm to the machine.

Replacement: as shown in the following picture, detach the plastic screw and take off the plastics. Then detach the fixed screw of the static-removing bar. Now it is time to replace the static-removing bar. If the spare bars are used up, please contact the after-safe personnel for help.

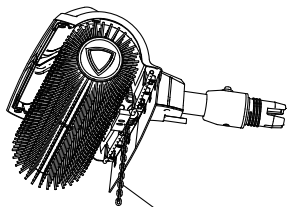
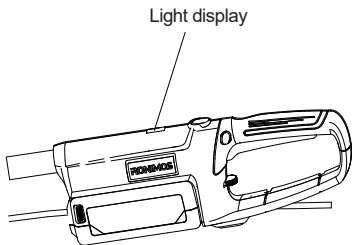

Startup & Shutdown

After finishing the product assembly, please press the self-locking button before the startup. Slightly press the start switch to start the machine. If the self-locking button is not pressed, the start switch will be in a locked state. When releasing the start switch, the start switch will bounce back and the machine is off at a time the self-locking button is bouncing back to restore its place.

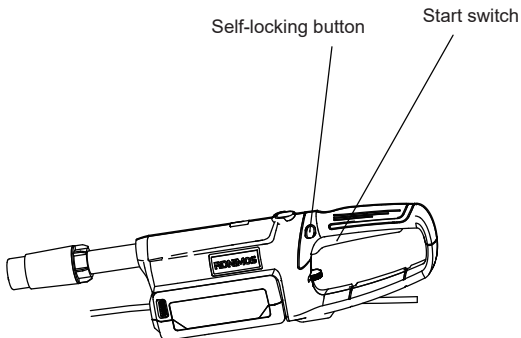

Cruise switch

When the machine is on, turn the cruise switch to the right, then the start switch can be locked for a start state and realize cruise. In the cruising state, turn the cruise switch to the left to reset state, and then the cruising state is relieved.

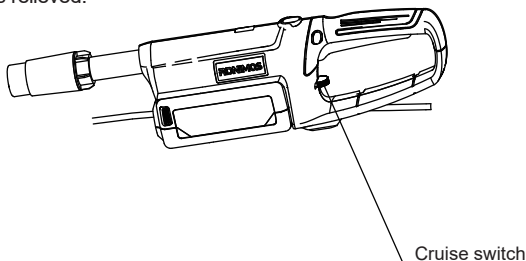

Bail-out

Description: As shown in the following picture, if the component of the machine runs out accidentally, please stay calm and slightly press the bail-out button but in avoidance of continually pressing the bail-out button. At this time, the machine will stop working and reverse in 5 seconds to bail out.

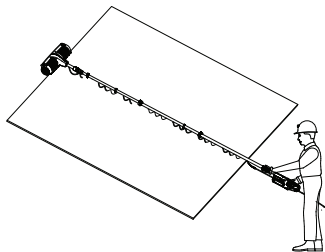
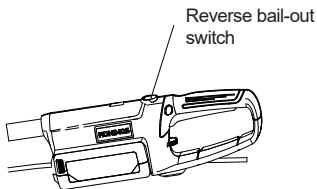

Warning

Do not frequently operate the trap release switch (positive and negative button), the positive and negative switch function is only used for trap release. Working state, frequent operation of release switch (motor positive and negative switching), motor damage risk.

Charging

When there is only 1 lamp of the power indicator of the host machine or of the battery pack is luminous, it indicates that the power is running low and timely replacement of a battery pack is needed at this moment. Connect the power charger for charging. If the power indicator turns red, it shows that the battery is being charged and if the power indicator is blue, it means that the battery is fully charged or disconnected.

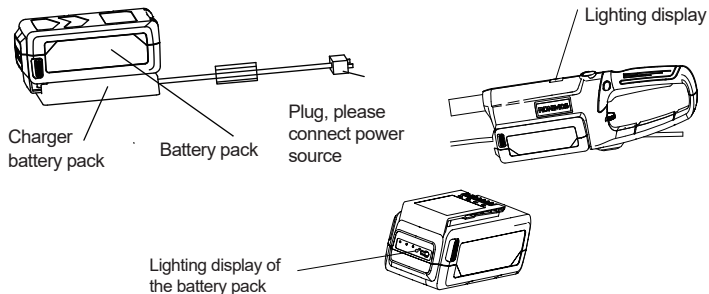

Lighting lamp

In the startup state of this machine, it is reasonable to press the lighting lamp switch slightly to switch on the lighting lamp when the light is insufficient. And to close the lighting lamp for disuse, just slightly press the lightning lamp switch.

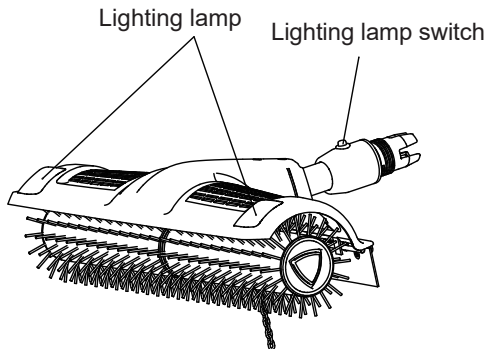

When the machine is in use, when the circuit is overloaded and overheated beyond the threshold, the fuse will blow out. Replacement: use a slotted screwdriver to pry open the cover plate of the fuse base compartment, pull out the fuse base, unscrew the fuse base, replace the round fuse, cover the cover plate, and complete the fuse replacement.

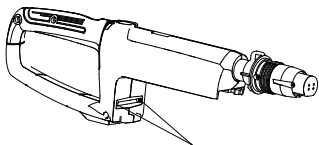

Fuse bin cover plate

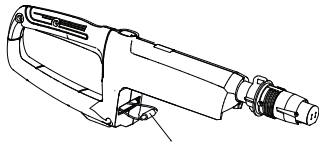

Fuse holder

Product assembly and usage scenarios

- Usage scenarios

Direction for using external power supply

The machine is equipped with external power pack and external power supply socket that can be used with external power supply. Insert the battery pack into the power source pack, connect the external power supply socket to the battery storehouse and then plant the power plug of the other end into the power port of the host battery storehouse. Then the assembly work is done.

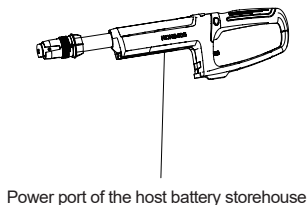
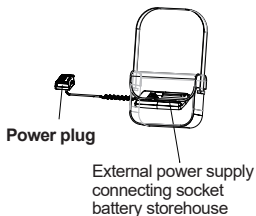

There are two available usage scenarios of the machine: dry-cleaning pattern and wet-cleaning pattern.

Dry-cleaning pattern:

It is selective when the pollution degree of the photovoltaic module is not serious.

Wet-cleaning pattr:

When the pollution degree of the photovoltaic module or other component is serious and it is relatively dry with comparable much oil dirties, the wet-cleaning pattern is selective. To start the pattern, connect the water inlet pipe of the unit to the water source of the pump. Water is sprayed through the spray pipe to realize cleaning. The quantity of water can be adjusted according to the pollution degree through the water control valve on the hand shrank position. It is suggested to add some environmental-friendly cleaner if the oil pollution is serious for better cleaning effect.

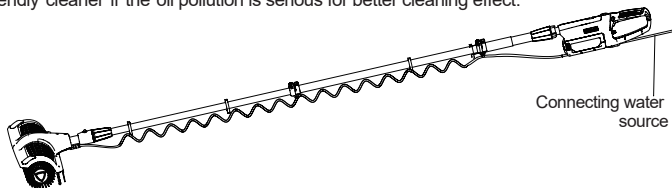

Operating instructions for extension rod assembly (optional)

When the operation distance is long, the extension rod assembly can be selected. The connection method is shown in the following figure. After connection, tighten the connecting sleeve.

Note: when connecting the extension rod assembly, do not lift the machine head to avoid damage to the rod.

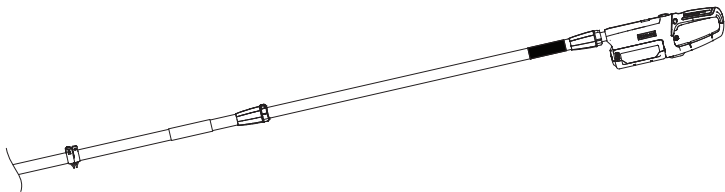

Product clean and maintenance

- Product clean

The clean and maintenance of the hairbrush

After using the hairbrush for a period of time, if its surface gets dirty, it can be cleaned through the water spray pipe in the wet-cleaning pattern directly. If it is really dirty, it is reasonable to use a flat-head screwdriver to pry open the side end cover, dismantle the side nut of the rolling brush, and pull out the rolling brush for cleaning. It is recommended to replace the roller brush half a year after frequent use.

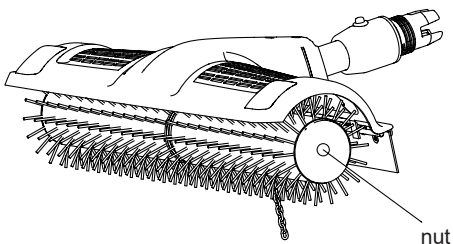
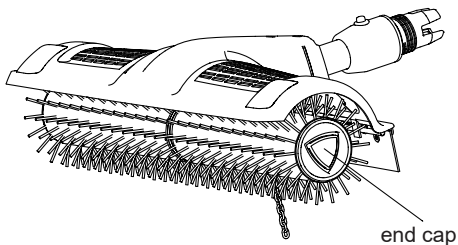

Product clean and maintenance

- Common malfunctions and solutions

Malfunctions	Possible reasons	Solutions
Inoperative machine	1. Low battery quantity	Charge in time
	2. Not press the machine power switch	Press the power switch
	3. The red fault light is lighting-disconnecting; the fault light is flickering-short circuit.	Stop using and contact the after-sale personnel

- Illustrative table for toxic and detrimental substance elements of the product

Component name	Detrimental elements					
	Lead	Mercury	Cadmium	hexavalent chromium	PBB	PBDE
Plastics	○	○	○	○	○	○
Electric machin	X	○	○	○	○	○
Circuit board and component	○	○	○	○	○	○
Adapter	○	○	○	○	○	○
Metal parts	○	○	○	○	○	○
Battery	○	○	○	○	○	○
Others	○	○	○	○	○	○

The table is compiled in line with regulations of SJ/T11364.

○: suggests that the content of this detrimental substance in all homogeneous materials of the component is below the limit requirements specified in 201165/ EU(RoHS)Directive and its Annex II amending directive 2015/863/ EU Test with reference to EN 62321-1:2013, EN 62321-2:2014, EN 2321-3-1:2014, EN 62321-4:2014A12017, EN 2321-5:2014, EN 62321-6:2015, EN 2321-7-1:2015, EN 2321-7-2:2017 and EN 2321-8:2017.

x: suggests that the content of the detrimental substance in at least One homogeneous material of the component exceeds the limit requirements specified in 201165/ EU(RoHS)Directive and its Annex II amending directive 2015/863/ EU Test with reference to EN 62321-1:2013, EN 62321-2:2014, EN 2321-3-1:2014.



NOTICES:

- The product contains lithium battery. When discarding the product, be sure not to resolve the battery and not to pile up with household wastes to prevent environment pollution. Please deliver to the appointed recycle stations or professional personnel for disposing.
- Be sure not to dismantle the machine. If the nameplate of the host is damaged artificially, the machine is out of the repair warranty. If the machine undergoes breakdowns in normal use, please contact the after-sale personnel of the manufacturer in time.
- Manufacturer :Suzhou Radiant Photovoltaic Technology Co., Ltd.
- Address: No.636 Zixu Road,Xukou Town,Suzhou, China 215100
- Phone number: 86-512-66572916



Environmental protection For EU countries only

Never place any electric power tools in your household refuse.

Li-ion

To comply with European Directive 2012/19/EU concerning old electric and electronic equipment and its implementation in national laws, old electric power tools have to be separated from other waste and disposed of in an environment-friendly fashion, e.g. by taking to a recycling depot.

Recycling alternative to the return request:

As an alternative to returning the equipment to the manufacturer, the owner of the electrical equipment must make sure that the equipment is properly disposed of if he no longer wants to keep the equipment. The old equipment can be returned to a suitable collection point that will dispose of the equipment in accordance with the national recycling and waste disposal regulations. This does not apply to any accessories or aids without electrical components supplied with the old equipment.